

BIEMME

FINESTRE

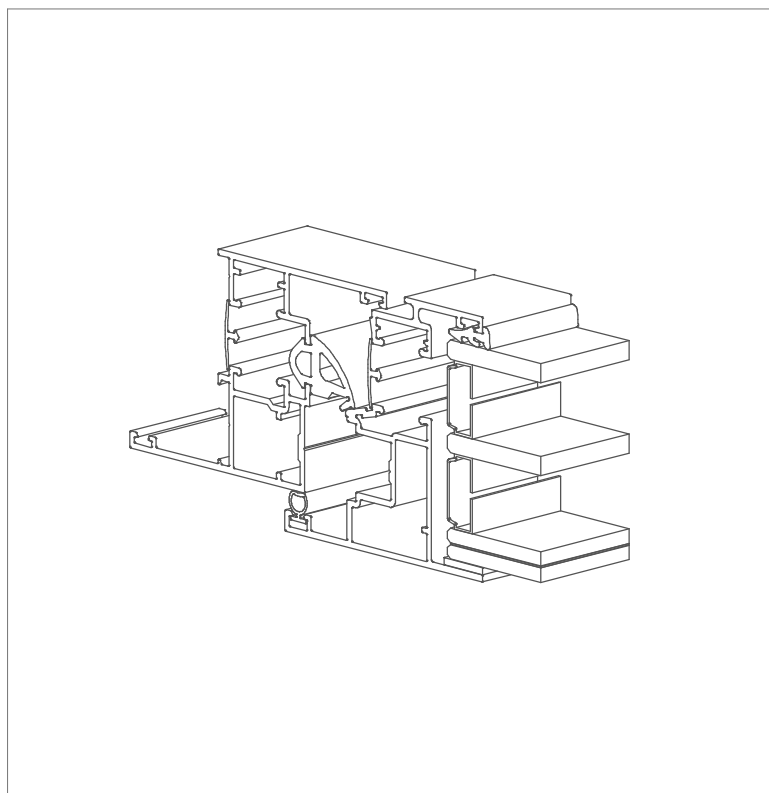

TAVOLE TECNICHE

LUNICA

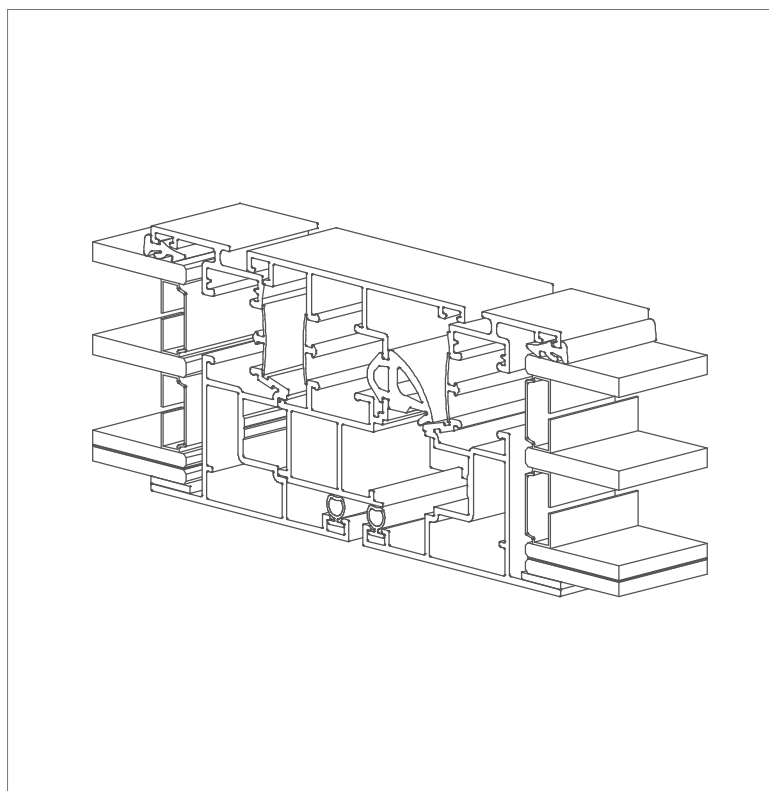

LUNICA

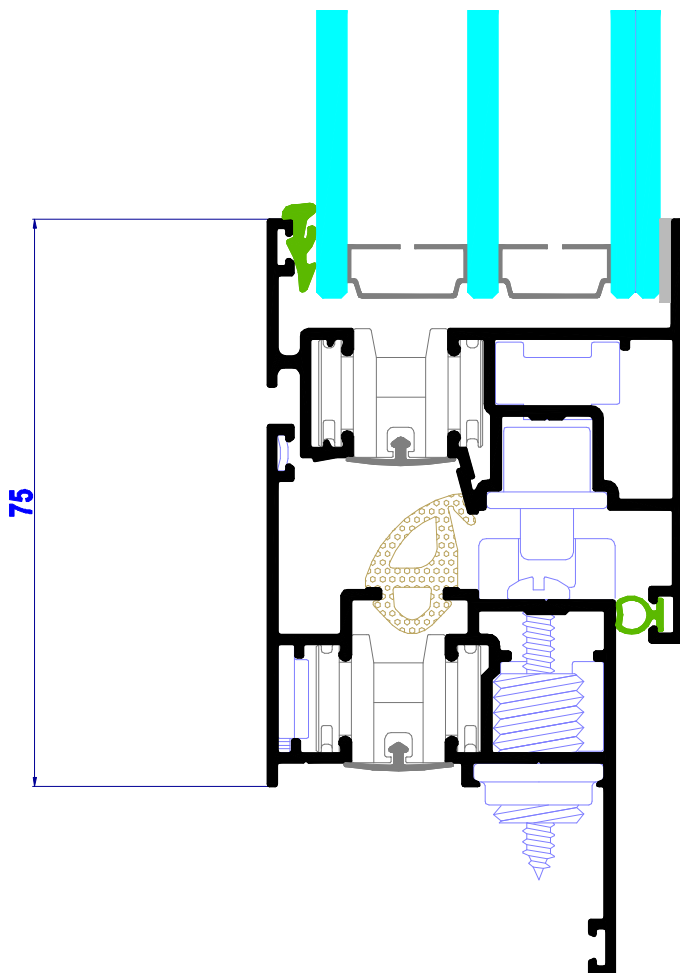

■ Valore fuori norma e limite 1.8 - 1.4

■ Valore valido per limite 1.4

■ Valore valido per limite 1.8

Prestazioni Isolamento Termico

Valori Serramenti Standard

Tipologia	Dimensioni UNI EN 14351-1+A1 2010	N° Rapporto Prova	Trasmittanza Termica serramento		
			Vetro Ug = 1.1 WE	Vetro Ug = 0.6 WE	Vetro Ug = 0.5 WE
Finestra 1 Anta	935 X 1480	RDP_N_1341_18 Cert(TV)	1.73	1.35	1.28
Finestra 2 Ante	1535 X 1480	RDP_N_1341_18 Cert(TV)	1.78	1.41	1.33
Portafinestra 1 Anta	935 X 2180	RDP_N_1341_18 Cert(TV)	1.69	1.31	ND
Portafinestra 2 Ante	1535 X 2180	RDP_N_1341_18 Cert(TV)	1.74	1.36	ND

Prestazioni di Tenuta e Meccaniche

Tipologia	Dimensioni	N° Rapporto Prova	Permeabilità Aria	Tenuta All'Acqua	Resistenza Carico Vento
Finestra 2 Ante con Ribalta	1350 X 1550	L19 / 0147_01	Classe 4	E 750	C 5

BIEMME

FINESTRE

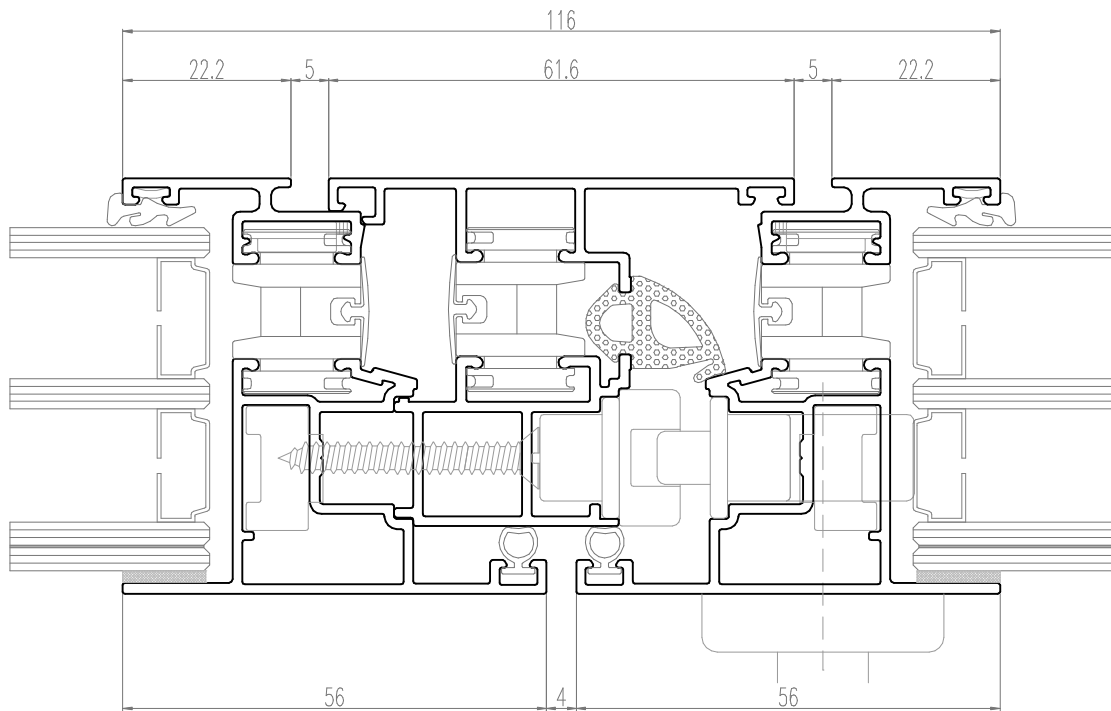
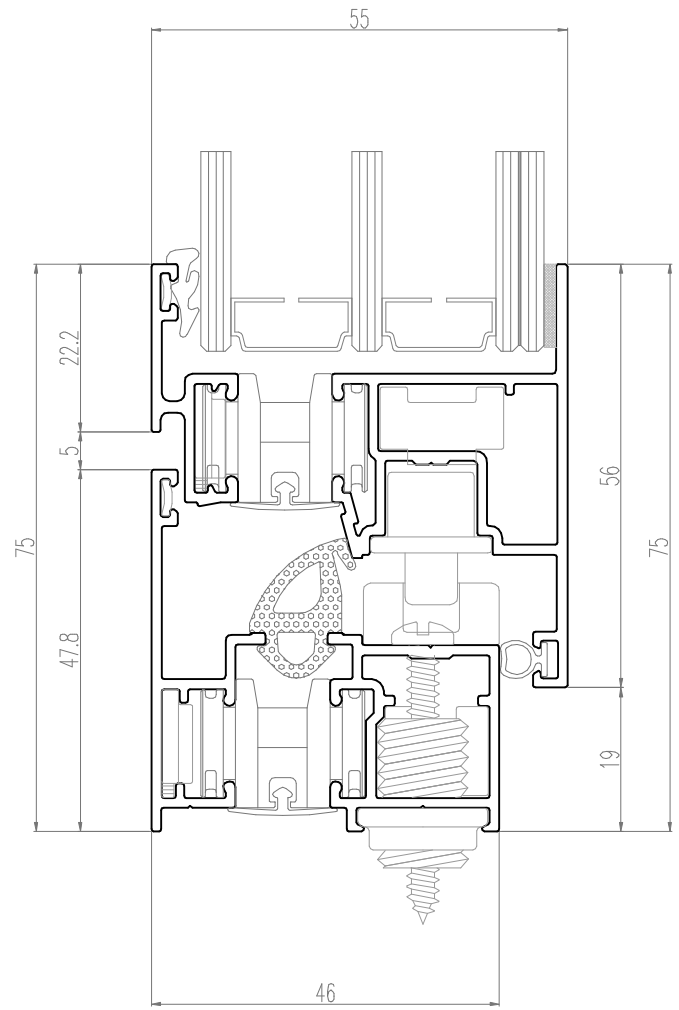
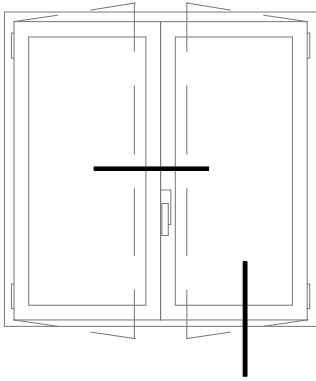

BIEMME

FINESTRE

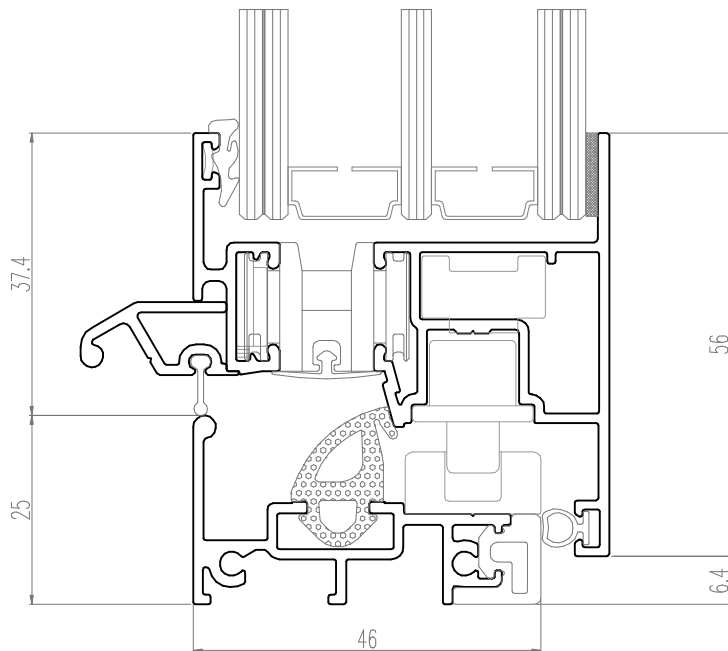
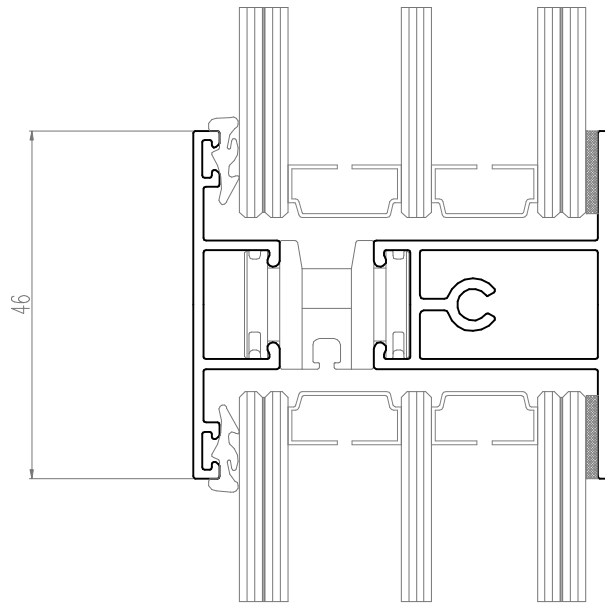
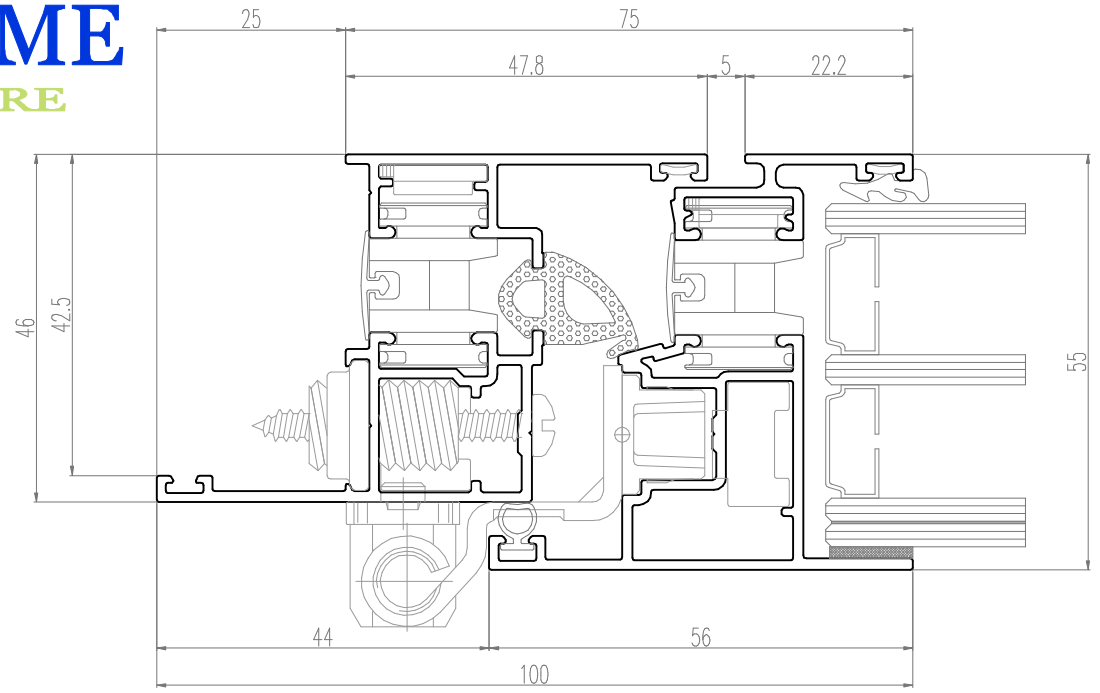
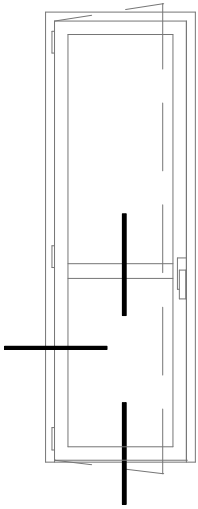

BIEMME

FINESTRE

